

INTERNALLY MOUNTED ROOF PANEL WITH MAINTAINED LIGHT (NOT SHOWN)

WEATHER RESISTANT ALUMINIUM ROOF PANEL (SHOWN THIS VIEW ONLY)

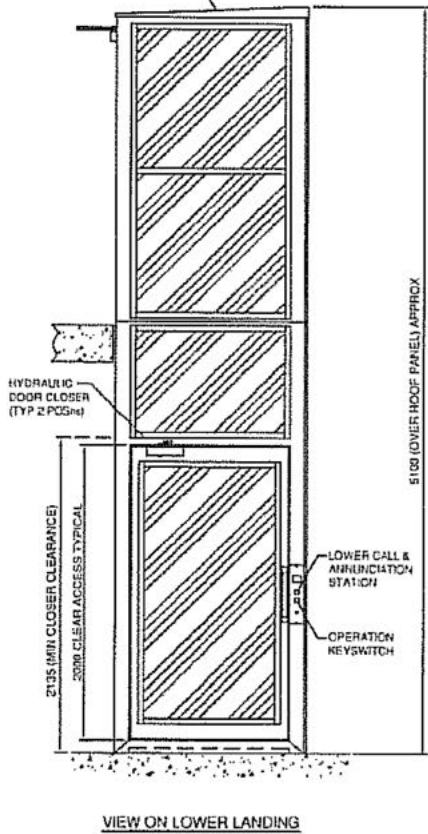
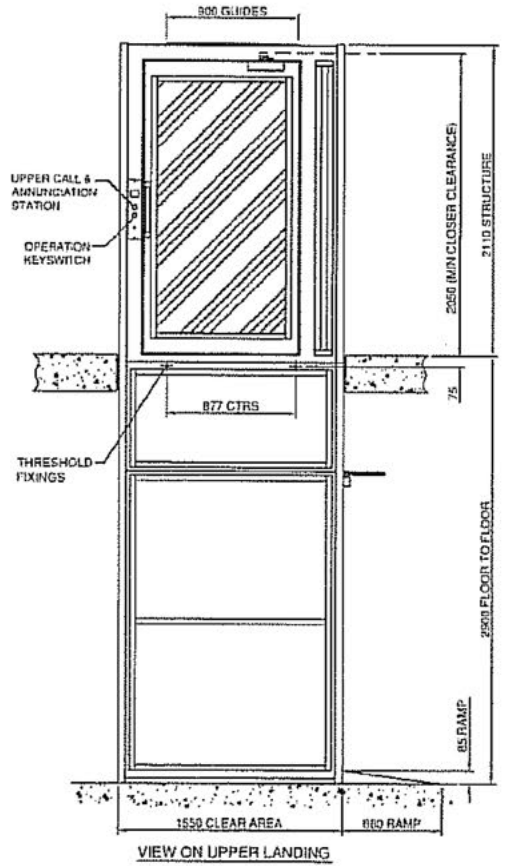
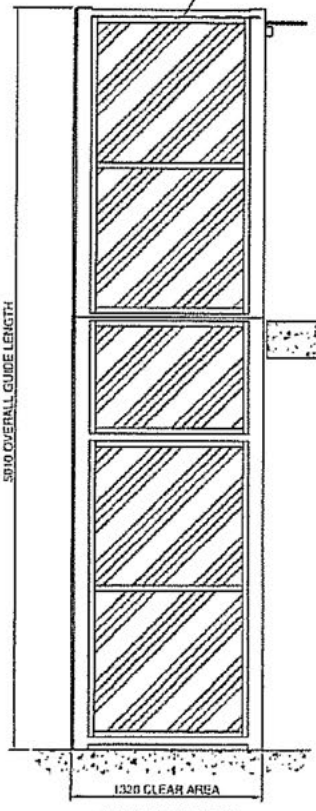

UPPER CALL & ANNUNCIATION STATION

OPERATION KEYSWITCH

THRESHOLD FIXINGS

HYDRAULIC DOOR CLOSER (TYP 2 PCGHe)

LOWER CALL & ANNUNCIATION STATION

OPERATION KEYSWITCH

EXTERNAL LIFT - PAINTED STAINLESS STEEL (MARINE SPEC)

A	28.8.13	NEW DRAWING	PSB	
Issue	Date	Description	Designed by	Approved by

FOR APPROVAL

BNALIFTS LIMITED
 6 Falcon Park,
 Claymore,
 Tame Valley Industrial Estate
 Tamworth
 Staffordshire, B77 5DQ

PROJECT NAME: _____
 SITE ADDRESS: _____
 DRAWING TITLE: _____
 REFERENCE No: _____

Tel: 0845 468 2543	Fax: 0845 006 1275	FILE No:	DWG No:	Issue	Page
--------------------	--------------------	----------	---------	-------	------

CONSTRUCTION NOTES

THE FOLLOWING WORK SHALL BE COMPLETED PRIOR TO LIFT INSTALLATION PROCEDURE.

1. IF REQUIRED, A SUITABLY SIZED PIT SHALL BE EXCAVATED WITH A SMOOTH AND LEVEL FINISH. IF NO PIT IS REQUIRED THE INSTALLATION AREA SHALL BE CLEAR OF DEBRIS, SMOOTH AND LEVEL.
2. IF REQUIRED, BUILDER SHALL PROVIDE WITHIN BUILDING, SUPPORTS FOR FIXING ENCLOSURE IN LOCATIONS SHOWN ON GENERAL ASSEMBLY DRAWING (SHEET 1).
3. 100kg PUSH-IN / PULL-OUT LOAD SHALL BE IMPOSED ON BUILDING STRUCTURE AT GUIDE FIXING POINTS TO ACCOMODATE LIFT OPERATION.

GENERAL INFORMATION

1. ASSISTANCE WITH THE OFF-LOADING OF EQUIPMENT
2. THERE SHALL BE CLEAR ACCESS TO INSTALLATION AREA
3. A SECURED AREA SHALL BE MADE AVAILABLE, ADJACENT TO INSTALLATION FOR STORAGE OF TOOLS AND EQUIPMENT
4. INSTALLATION AREA SHALL BE CLEAR OF DEBRIS AND SITE PERSONNEL FOR THE DURATION OF THE LIFT INSTALLATION
5. BUILDER SHALL PROVIDE HOARDINGS OR BARRIERS TO PROTECT UPPER LANDING AREA FOR THE DURATION OF LIFT INSTALLATION
6. INSTALLATION AREA MUST BE ADOUATLY ILLUMINATED
7. 110v POWER SUPPLY SHALL BE MADE AVAILABLE FOR USE OF POWER TOOLS ETC
8. FACILITIES FOR BOTH WASHING AND FIRST AID CARE TO BE MADE AVAILABLE

ELECTRICAL INFORMATION

1. PROVISION MUST BE MADE FOR A DEDICATED 240v AC 13A SUPPLY TERMINATING IN A 13A SWITCHED, FUSED AND LOCKABLE ISOLATOR.
2. PROVIDE A TWIN SOCKET OUTLET ADJACENT TO INSTALLATION FOR POWER TOOLS AND LIGHT LEAD EXTENSIONS FOR MAINTENANCE INSPECTIONS
3. ENSURE THE LIGHTING AT ALL FLOOR LEVELS IS NOT LESS THAN 50LUX WHEN MEASURED AT FLOOR LEVEL
4. AUTODIALLER - A DEDICATED ANALOGUE BT LINE, TERMINATING IN A BT SOCKET, MUST BE POSITIONED NEXT TO THE CONTROL BOX. THE TELEPHONE NUMBER OF THE LINE SUPPLIED AND ITS ASSOCIATED NUMBERS (max 5) WHICH WILL DIALLED IN THE EVENT OF ACTUATION FOR AN EMERGENCY.

REQUIREMENTS FROM CLIENT FOR OPTIONAL EXTRAS

1. REMOTE ALARM SOUNDER - CLIENT TO SUPPLY A TWO CORE CABLE (0.75mm) FROM THE LIFT CONTROL BOX TO THE POSITION IN WHICH THE REMOTE ALARM IS TO BE MOUNTED.
2. REMOTE KEY ISOLATION - CLIENT TO SUPPLY A THREE CORE CABLE (0.75mm) FROM THE LIFT CONTROL BOX TO THE POSITION IN WHICH THE REMOTE KEYSWITCH IS TO BE MOUNTED.
3. INTERCOM - CLIENT TO SUPPLY A NINE CORE CABLE (0.75mm) FROM THE LIFT CONTROL BOX TO THE POSITION IN WHICH THE INTERCOM MASTER STATION IS TO BE MOUNTED. THE INTERCOM MASTER STATION IS MOUNTED ON A FLUSH MOUNT BACK-BOX THAT WILL NEED TO BE RECESSED INTO THE WALL BY THE CLIENT.

TECHNICAL SPECIFICATION

- | | |
|---|-----------|
| 1. CONTRACT LOAD | 400Kg |
| 2. PLATFORM SPEED IF TRAVEL IS LESS THAN 1400mm | 0.08m/sec |
| 3. PLATFORM SPEED IF TRAVEL EXCEEDS 1400mm | 0.10m/sec |
| 4. CONTROL SYSTEM VOLTAGE | 24v |
| 5. POWER SUPPLY | 240v 13A |

ELECTRICAL DATA

- | | |
|---------------------|--------|
| 1. MOTOR | 0.55kW |
| 2. STARTING CURRENT | 18A |
| 3. RUNNING CURRENT | 4.5A |

CONTROL CABINET INFORMATION

THE SUPPLIED CONTROL CABINET SHALL BE A WEATHER PROOF CONSTRUCTION TO IP65 STANDARD AND SHALL BE MOUNTED IN A SUITABLE POSITION NOT MORE THAN 5Mtrs FROM THE GUIDE BASE PLATE.
THE FINAL POSITION OF THE CONTROL CABINET SHALL BE AGREED BEFORE LIFT INSTALLATION COMMENCES UNLESS SHOWN ON LIFT GENERAL ASSEMBLY LAYOUT.
THERE MAY BE A NECESSITY FOR THE BUILDER TO CHASE ONE SUB-SURFACE CONDUIT RUN FROM THE GUIDE SIDE OF THE LIFT ENCLOSURE TO THE CONTROL CABINET (MIN SIZE = 75mm SQ). THERE SHALL BE ADEQUATE LIGHTING AND ACCESS TO THE CONTROL CABINET FOR MAINTENANCE AND EMERGENCY PROCEDURES TO BE CARRIED OUT

WEIGHT: 90 - 140 Kg's

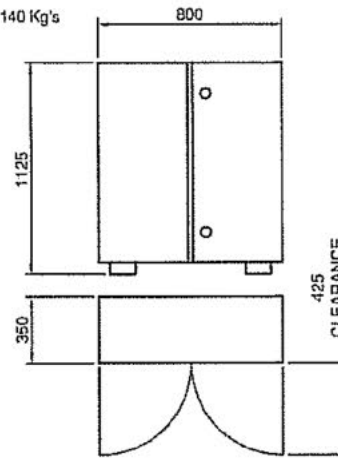

ENCLOSURE LOADING DIAGRAM

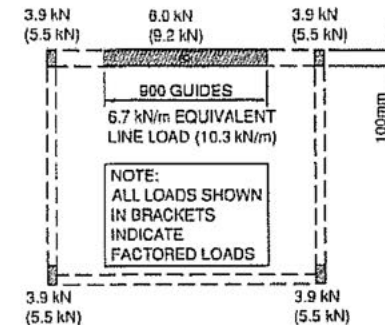

⊙ DENOTES THE POINT AT WHICH THE HYDRAULIC RAM IS PLACED.

THE OVERALL ENCLOSURE WEIGHT IS DEPENDANT ON THE FLOOR TO FLOOR TRAVEL DIMENSION.

THE ENCLOSURE LOADING DIAGRAM IS SHOWN FOR INFORMAL PURPOSES ONLY, AND IS BASED ON A LIFT OF 6000mm FFL / FFL AND AN ENCLOSURE WEIGHT OF 1750kgs.

A	28.8.13	NEW DRAWING	PSD	
Issue	Date	Description	Designed by	Approved by
FOR APPROVAL				
INVALIFTS LIMITED 6 Falcon Park, Claymore, Tame Valley Industrial Estate Tamworth Staffordshire. B77 500 Tel: 0845 468 2543 Fax: 0845 005 1275		PROJECT NAME: SITE ADDRESS: DRAWING TITLE: REFERENCE No:		
FILE No:	DWG No:	Issue	Page	